



May 12-14



2017 Brick Hockey Club Training

@ Compton Family Ice Arena

PARTICIPATION GUIDE

University of Notre Dame



Brick Training at Notre Dame

Table of Contents

Brick Contacts	3
2009 Futures Schedule	4
2008 Futures Schedule	5
2007 Brick Schedule	6
Directions	7
Map & Parking Information	8
Arena Details	9
Arena Map	10
Local Hospitals	11
South Bend/Mishawaka Map	12
Area Restaurants	13
Area Attractions	14
Participation Waiver	15



Brick Contacts

Barbie Purpura – Barbie@200x85.com

(708) 774-9580

Administrative Director

Ryan Taylor – taylorbms@aol.com

(312) 925-5656

Brick Hockey Club Director / Chicago Jr. Blackhawks Head Coach

Justin Lewandowski – justin@200x85.com

(630) 201-4490

Brick Director of Player Development

Mark Roy – mark@200x85.com

(630) 441-3949

Brick Futures 2008

Brandon Lewandowski – blewandowski369@gmail.com

(630) 696-5535

Brick Futures 2008

Christian Hmura – clhmura@hotmail.com

(815) 351-7779

Brick Futures 2009



2009 Futures Schedule

2009

FRI, MAY 12	Day	Time	Hours	Rink
2009 On Ice Training	Friday	12:30-1:30pm	1:00	Olympic
NUTRITION LECTURE	Friday	2:00-2:30pm	:30	Seminar
2009 On Ice Game	Friday	4:10-5:10pm	1:00	Lefty
SAT, MAY 13	Day	Time	Hours	Rink
2009 On Ice Training	Saturday	8:00-9:00am	1:00	Lefty
OFF ICE TRAINING	Saturday	9:20-10:20am	1:00	Concourse
LOCKER TOUR	Saturday	10:30-11:00am	:30	Locker Rm
2009 On Ice Training	Saturday	11:40-12:40pm	1:00	Olympic
GOALIE CLINIC	Saturday	1:50-3:00pm	1:10	Lefty
2009 On Ice Game	Saturday	5:20-6:20pm	1:00	Olympic
SUN, MAY 14	Day	Time	Hours	Rink
2009 Final Game	Sunday	7:30-8:45am	1:15	Olympic



2008 Futures Schedule

2008

FRI, MAY 12	Day	Time	Hours	Rink
2008 On Ice Training	Friday	1:40-2:40pm	1:00	Olympic
NUTRITION LECTURE	Friday	3:20-3:50pm	:30	Seminar
2008 On Ice Game	Friday	5:20-6:20pm	1:00	Lefty
SAT, MAY 13				
SAT, MAY 13	Day	Time	Hours	Rink
2008 On Ice Training	Saturday	8:10-9:10am	1:00	Olympic
LOCKER TOUR	Saturday	11:45-12:15pm	:30	Locker Rm
2008 On Ice Training	Saturday	12:40-1:40pm	1:00	Lefty
GOALIE CLINIC	Saturday	1:50-3:00pm	1:10	Lefty
OFF ICE TRAINING	Saturday	3:10-4:10pm	1:00	Concourse
2008 On Ice Game	Saturday	6:30-7:30pm	1:00	Olympic
SUN, MAY 14				
SUN, MAY 14	Day	Time	Hours	Rink
2008 Final Game	Sunday	8:55-10:10am	1:15	Olympic



2007 Brick Schedule

2007

FRI, MAY 12	Day	Time	Hours	Rink
2007 On Ice Training	Friday	12:40-1:40pm	1:00	Lefty
NUTRIRION LECTURE	Friday	2:40-3:10pm	:30	Seminar
2007 On Ice Game	Friday	5:10-6:10pm	1:00	Olympic
SAT, MAY 13	Day	Time	Hours	Rink
LOCKER TOUR	Saturday	8:15-8:45am	:30	Locker Rm
2007 On Ice Training	Saturday	9:10-10:10am	1:00	Lefty
OFF ICE TRAINING	Saturday	10:30-11:30am	1:00	Concourse
2007 On Ice Training	Saturday	12:50-1:50pm	1:00	Olympic
GOALIE CLINIC	Saturday	1:50-3:00pm	1:10	Lefty
2007 On Ice Game	Saturday	5:30-6:30pm	1:00	Lefty
SUN, MAY 14	Day	Time	Hours	Rink
2007 On Ice Training	Sunday	7:40-8:55am	1:15	Lefty



Directions

From Indiana Toll Road:

Use Exit 77 (South Bend/Notre Dame). Turn right (south) onto SR 933/Bus.31. Go south - at Angela Rd. turn left (east). Go East, turn left (north) onto Joyce Dr. Compton Family Ice Arena is located on the right (Corner of Joyce and Angela). Bus loading/unloading will be at the North/Main Entrance of the arena.

From Indianapolis:

Follow U.S. 31 North. That becomes SR 933/Bus.31 just south of South Bend. Proceed through South Bend and continue north. Turn Right (east) onto Angela Rd. Go east, turn left (north) onto Joyce Dr. Compton Family Ice Arena is located on the right (corner of Joyce and Angela). Bus loading/unloading will be at the North/Main Entrance of the arena.

From O'hare Airport:

Take Route 190 east out of O'Hare to Route 90 east (Kennedy Expressway) toward downtown Chicago. Merges with Route 94 south (Dan Ryan Expressway). Take Skyway exit off the Dan Ryan and remain on Route 90 to Indiana Toll Road. Eventually merges with Route 80. Use Exit 77 (South Bend/Notre Dame).

Notes:

An alternative route: Take Route 190 east out of O'Hare to Interstate 294 south (Tri-State Tollway) and follow the signs for 80/294 and then Interstate 80-90 (Indiana Toll Road). Use Exit 77 (South Bend/Notre Dame).



Map and Parking Information

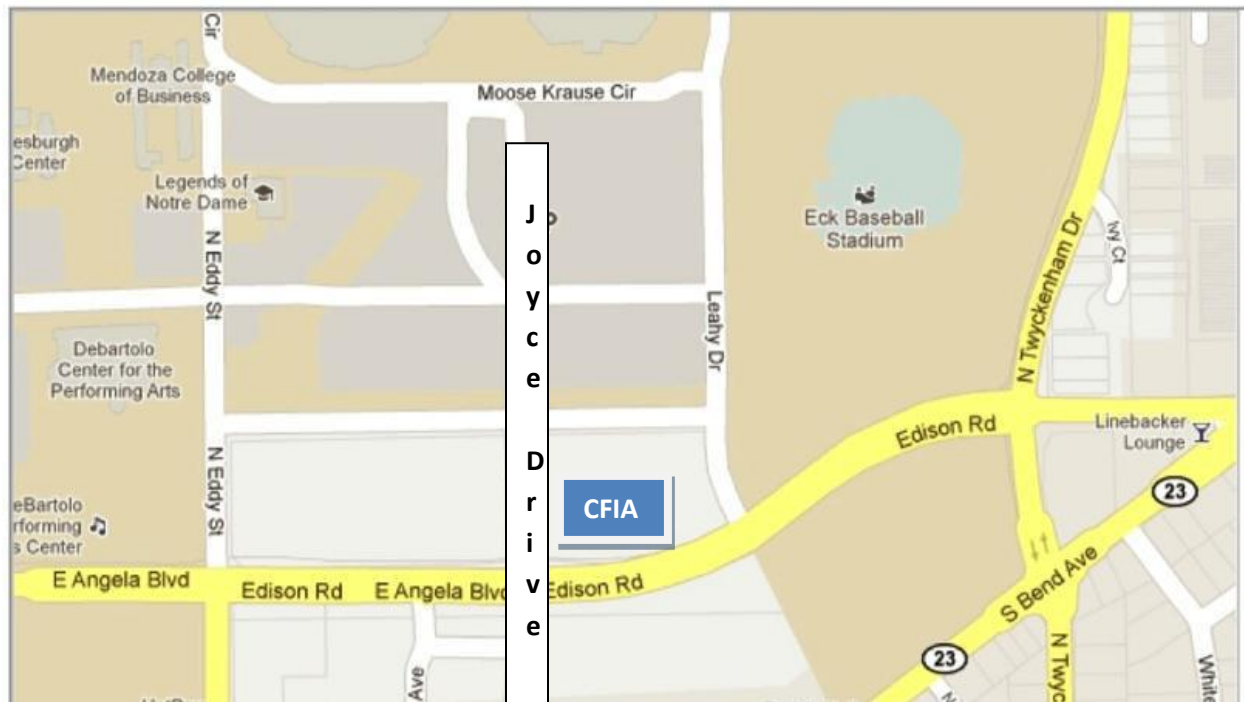

General Parking:

All other Vehicles can park in any of the Joyce Center or Compton Family Ice Arena Lots.



Arena Details

Opened in October 2011, the Compton Family Ice Arena anchors the south edge of campus, adjacent to the Joyce Center and west of the Irish track and field facility. The state-of-the-art arena houses two ice rinks and was designed to support the Notre Dame hockey programs and those in the local community. The facility was made possible by a generous lead gift from Kevin and Gayla Compton, who also own the San Jose Sharks of the National Hockey League (NHL). With its eye-catching, barrel-vaulted roof and bow trusses, the main arena has two levels with a capacity of 5,000—both seated and standing room combined—with the majority of the seats a comfortable, chair-back style. The student section and hockey band seating are located on the west end of both levels. O'Brien's, the exclusive club for Fighting Irish Hockey games, is located on the upper level, as well as mezzanine level seating and the media center. Open concourses on both levels provide ample standing room.

The Charles W. "Lefty" Smith Jr. Rink, the 200' x 90' playing surface of the main arena, honors the first coach in the Notre Dame hockey program. The Olympic-size rink can be divided into smaller rinks to be used by the Irish Youth Hockey League (IYHL) and support the USA Hockey Athlete Development Model (ADM), figure skating, public skating, and broomball. The building also houses numerous offices, locker rooms, and training facilities.





Arena Map

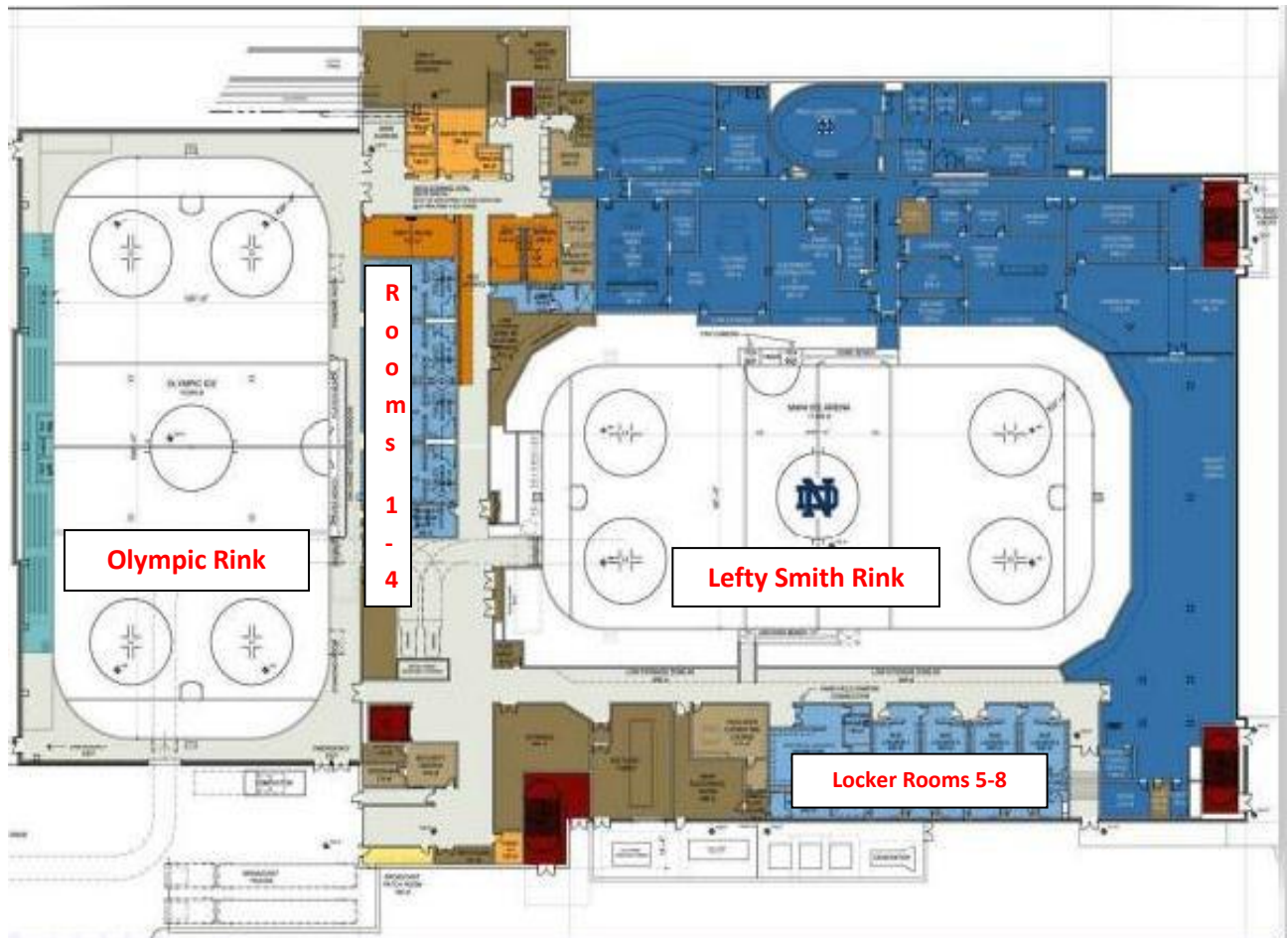



Local Hospitals

Memorial Hospital - Level II Trauma Center

615 N. Michigan St.

South Bend, IN 46601

574-647-1000

www.qualityoflife.org

Directions from CFIA: Turn West (right) onto Angela/Edison from CFIA. When you get to SR933/Business 31, turn South (left). Travel .7 miles and Memorial Hospital will be on the right.

St. Joseph Regional Medical Center

5215 Holy Cross Parkway (Intersection of Main & Douglas)

Mishawaka, IN 46545

574-335-5000

www.sjmed.com

Directions from CFIA: Turn East (left) onto Angela/Edison from CFIA. When you get to SR-23, turn North (Left). Travel to Douglas Rd., turn East (right). Travel 1.9 miles. St. Joseph Regional Medical Center will be on the right.

MedPoint

6913 North Main St.

Granger, IN 46530

574-647-1550

Directions from CFIA: Turn East (left) onto Angela/Edison from CFIA. When you get to SR-23, turn North (left). Travel 2.7 miles to Cleveland Rd., turn East (right). Travel 0.6 miles to Main St, turn South (right). MedPoint will be on the right.



South Bend/Mishawaka Map

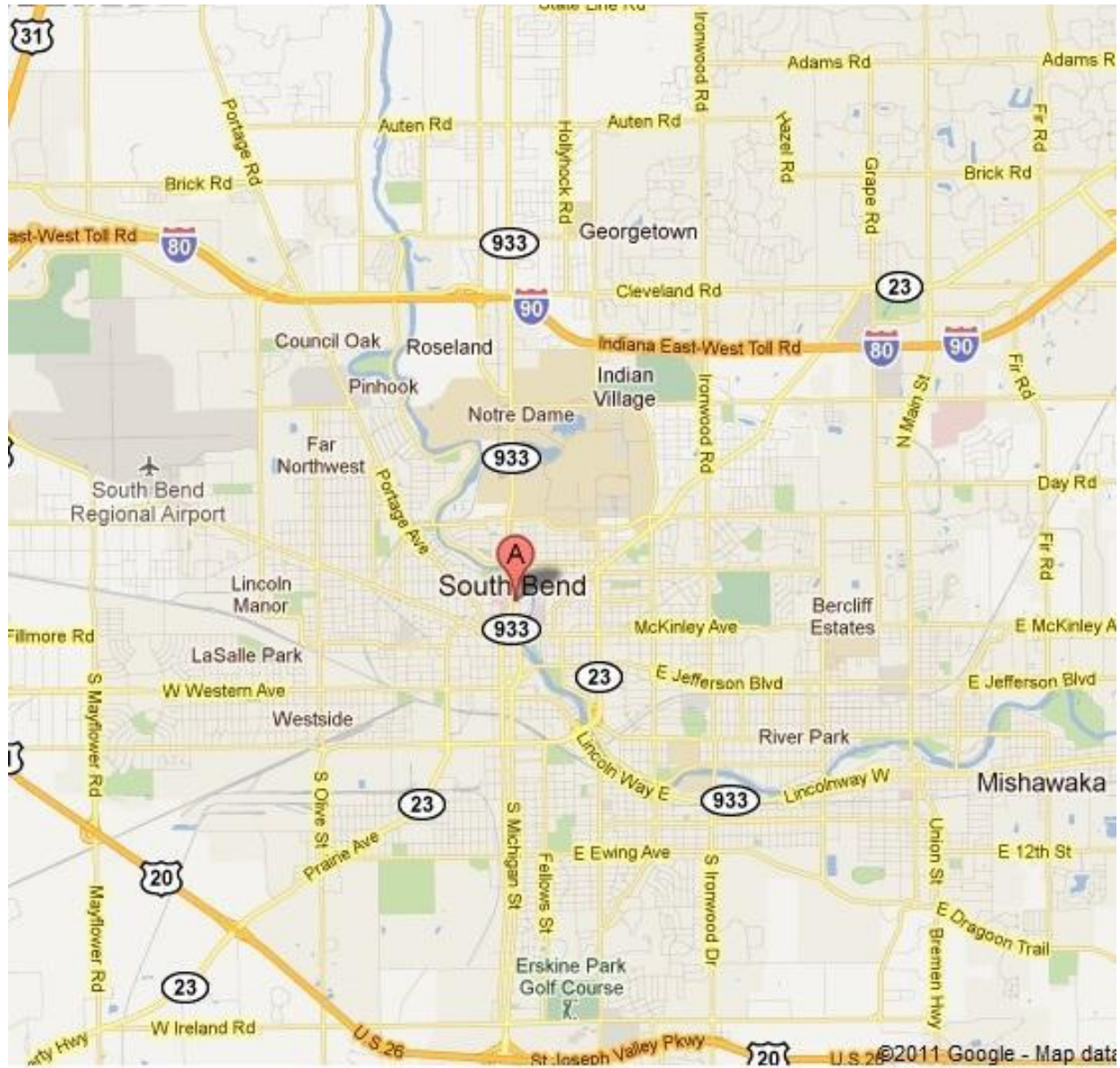



Area Restaurants

Parisi's Italian Ristorante

1412 South Bend Ave.
574-232-4244
0.5 miles from CFIA

Hot Box Pizza

1234 Eddy St.
574-246-9445
0.2 miles from CFIA

Five Guys Burgers & Fries

1233 Eddy St. #110
574-234-1800
0.2 miles from CFIA

The Mark Dine & Tap

1234 Eddy St. #111
574-204-2767
0.2 miles from CFIA

McAllister's Deli

1130 Angela Blvd. #102
574-232-8560
0.2 miles from CFIA

Rocco's Pizza

537 N. Saint Louis Blvd
574-233-2464
0.8 miles from CFIA

Between the Buns

1803 South Bend Avenue
574-247-9293
0.8 Miles from CFIA

Barnaby's

713 E. Jefferson Ave
574-288-4981
1.4 miles from CFIA

Original Pancake House

1430 N. Ironwood Dr.
574-232-3220
1.1 miles from CFIA

Tippecanoe Place

620 W. Washington St.
574-234-9077
1.7 miles from CFIA

Main Street Pub & Grill

2046 South Bend Ave
574-271-9895
0.9 miles from CFIA

Nick's Patio

1710 N. Ironwood Dr.
574-277-7400
1.1 miles from CFIA

Hacienda Mexican

1501 N. Ironwood Dr.
574-272-5922
1.0 miles from CFIA

Mulligan's Bar & Grill

1705 South Bend Ave.
574-277-5666
0.2 miles from CFIA

Studebagels

1801 South Bend Ave
574-277-4440
0.8 miles from CFIA

Carmela's at Macri's

214 N. Niles Ave
574-280-4824
1.2 miles from CFIA

Maury's Pat's Pub

901 West 4th St.
Mishawaka, IN
574-259-8282

Jimmy John's

54570 N. Ironwood
574-277-8500
1.1 miles from CFIA

Chipotle Mexican Grill

1250 N. Eddy #101
574-251-0175
0.2 miles from CFIA

Einstein Bagels

2019 South Bend Ave
574-272-2622
0.9 miles from CFIA

Domino's Pizza

1627 Edison Rd.
574-271-0300
0.1 miles from CFIA



Area Attractions

University Park Mall

www.simon.com/mall/?id-192

6501 N. Grape Rd. Mishawaka, IN 46545

College Football Hall of Fame

www.collegefootball.org

111 South St. Joseph St. South Bend, IN
1-800-440-FAME

Potawatomi Zoo

www.potawatomizoo.org

500 S. Greenlawn South Bend, IN 46615
574-235-9800

Morris Performing Arts Center

www.morriscenter.org

211 N. Michigan St. South Bend, IN 46601
574-235-9190

Studebaker Museum

www.studebakermuseum.org

201 S. Chapin St. South Bend, IN 46601
574-235-9714

South Bend Silverhawks Baseball

www.minorleaguebaseball.com/index.jsp?sid=t550

Coveleski Stadium
501 W. South St. South Bend, IN 46601
574-235-9988

**UNIVERSITY OF NOTRE DAME COMPTON FAMILY ICE ARENA
WAIVER, RELEASE, AND INDEMNIFICATION AGREEMENT FOR MINORS (YOUNGER THAN AGE 18)
2016-2017**

I, _____, am the parent or guardian of a minor child, _____, who will be participating in ice skating, ice hockey, and/or broomball activity (collectively "Activity") at the Compton Family Ice Arena ("Arena") at the University of Notre Dame du Lac, Notre Dame, Indiana (the "University") during the period of time starting with the date of my signature below through June 30, 2017. I am fully aware that my child's participation in this Activity is totally voluntary. In consideration of the University's agreement to permit my son or daughter to participate in the Activity, the receipt and sufficiency of which consideration is hereby acknowledged, I agree as follows:

1. I, individually, and on behalf of my minor child and our respective heirs, successors, assigns, and personal representatives, hereby release, acquit and forever discharge the University and its employees, agents, servants, officers, trustees, and representatives (in their official and individual capacities) from any and all liability whatsoever, excluding liability for the University's sole negligence, for any and all damages, losses or injuries (including death, mental anguish or emotional distress) to myself, my child and/or property, including but not limited to any claims, demands, actions, causes of action, damages, costs, expenses (including hospital and medical expenses) and attorneys' fees, which arise out of, occur during, or result from my child's participation in the aforementioned Activity, including travel to and from the University and including without limitation any loss, claim, demand or suit that my child might assert once he/she attains the age of majority.

2. I, individually, and on behalf of my minor child and our respective heirs, successors, assigns, and personal representatives, hereby agree to indemnify, defend and hold harmless the University and its employees, agents, servants, officers, trustees and representatives (in their individual and official capacities) from any and all liability, loss or damages incurred or sustained (including injury or damage to persons and/or property) as a result of any claims, demands, damages, actions, causes of action, judgments, costs, expenses (including hospital and medical expenses) and/or attorneys' fees, which result from, arise out of, or relate to my child's participation in the aforementioned Activity or arising out of his or her travel to and from the University.

3. I agree that this Waiver, Release, and Indemnification Agreement is governed by the laws of the State of Indiana and is intended to be as broad and inclusive as permitted by the laws of the State of Indiana. If any portion hereof is held invalid, it is agreed that the balance hereof shall, notwithstanding, continue in full legal force and effect. In the event of any cause of action related to the Activity, I agree that jurisdiction lies with the Superior Court of St. Joseph County, Indiana or the U. S. District Court of Northern District of Indiana.

4. I hereby acknowledge and accept that there are certain risks, known and unknown, including bodily injury and death, inherent in my child's participation in ice skating, the game of ice hockey, and/or the games of broomball or curling. I, on my own behalf and on behalf of my minor child, have knowingly and voluntarily decided to assume the risk of these inherent dangers in consideration of the University's permission to allow my minor child to participate in the aforementioned Activity. I hereby release and discharge the University from any and all negligence, excluding the University's sole negligence, in connection with my child's participation in the Activity, including travel to and from the University. I hereby acknowledge and agree that the University may permit my child to engage in any ice skating, ice hockey, curling or broomball activity at the Arena and that I assume sole responsibility for preventing my child from engaging in any ice skating, ice hockey, curling or broomball activity in which I do not want him/her to participate.

5. I hereby agree that, if my child engages in any ice hockey or broomball activity at the Arena, I shall have sole responsibility for ensuring that he/she will wear at all times while on the ice rink surface all protective equipment required by the Arena for such activity, including a helmet that meets the Arena's requirements. I hereby acknowledge that non-compliance with any such requirement may result in my child's ejection from the Arena on the date(s) on which the requirement is violated.

6. I hereby represent and warrant that, if my child will engage in any ice hockey activity at the Arena, he/she will be a current, registered member of USA Hockey, Inc. at the time of that ice hockey activity. I further agree that I shall prevent and shall have the sole responsibility for preventing my child from engaging in any ice hockey activity at the Arena during any period of time that my child is not a registered member of USA Hockey, Inc.

7. **By signing this Waiver, Release, and Indemnification Agreement, I hereby acknowledge and represent that I have read this entire document, that I understand its terms and provisions, that I understand that it affects my legal rights and those of my child, that it is a binding Agreement, and that I have signed it knowingly and voluntarily.**

Parent or Guardian Signature Parent or Guardian Name (Printed) Date

USA Hockey registration Confirmation Number (from USAH registration receipt): _____

Date of Birth: _____ Zip Code (used to register w/ USA Hockey): _____

Parent Email Address: _____ Cell Phone #: _____